

2

1

B

B

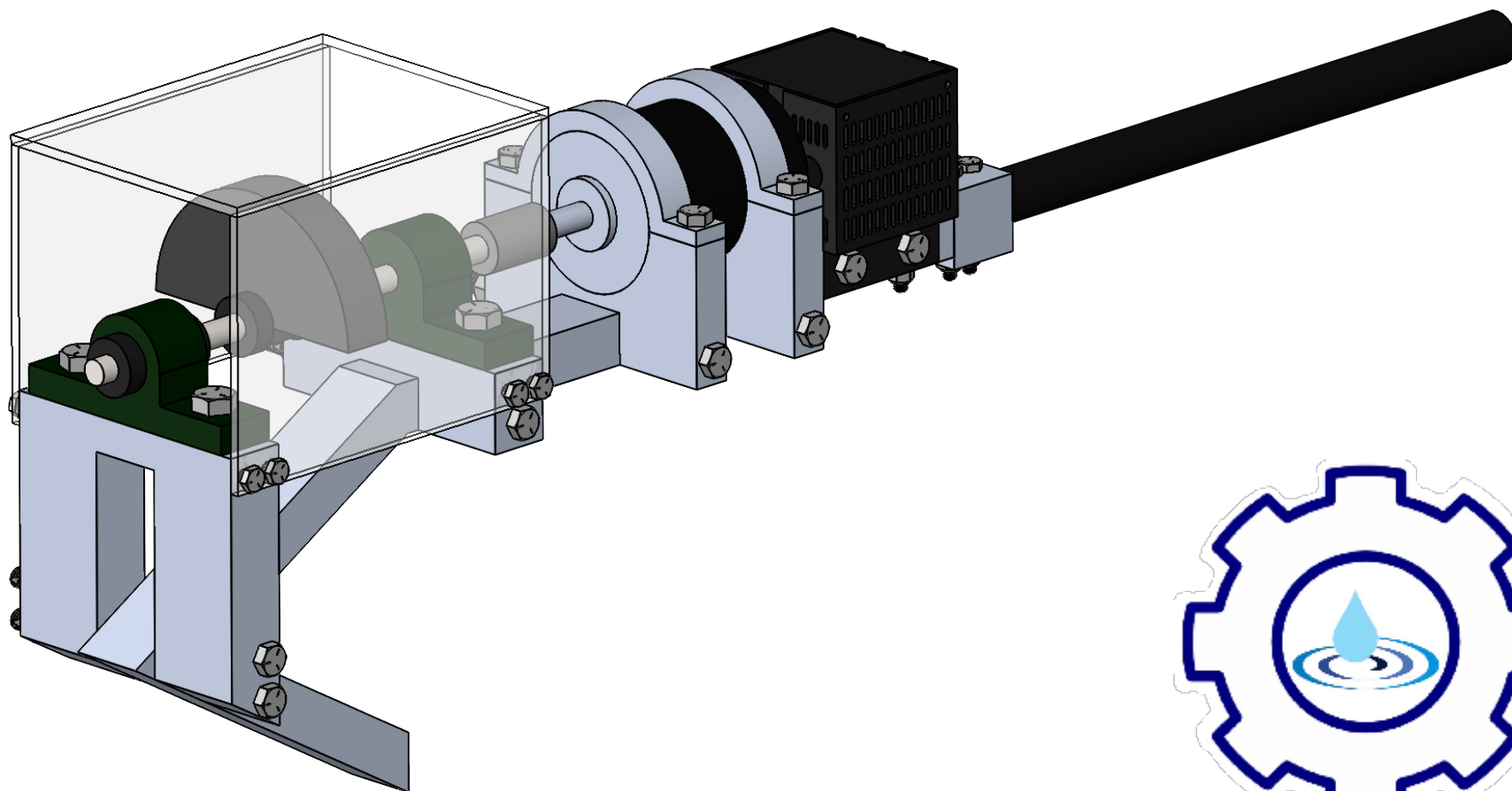

A

A

PROPRIETARY AND CONFIDENTIAL
 THE INFORMATION CONTAINED IN THIS DRAWING IS THE SOLE PROPERTY OF SDII T9 - RIPPLE EFFECT. ANY REPRODUCTION IN PART OR AS A WHOLE WITHOUT THE WRITTEN PERMISSION OF UTRGV IS PROHIBITED.

		UNLESS OTHERWISE SPECIFIED:		NAME	DATE
		DIMENSIONS ARE IN INCHES	DRAWN	MM	11/10/21
		TOLERANCES:	CHECKED		
		FRACTIONAL ±	ENG APPR.		
		ANGULAR: MACH ± BEND ±	MFG APPR.		
		TWO PLACE DECIMAL ±	Q.A.		
		THREE PLACE DECIMAL ±	COMMENTS:		
		INTERPRET GEOMETRIC TOLERANCING PER:			
		MATERIAL			
		N/A			
		FINISH			
		N/A			
NEXT ASSY	USED ON				
	APPLICATION	DO NOT SCALE DRAWING			

SDII T9 - Ripple Effect

TITLE:
 Mechanical Mesquite
 Bean Harvester

SIZE	DWG. NO.	REV
A	MechMBH	0
SCALE: 1:3	WEIGHT:	SHEET 1 OF 13

2

1

ITEM NO.	PART NUMBER	DESC.
1	Lower Motor Mounts - Hook Frame	Step 1
2	Lower Pillow Block Mount - Hook Frame	Step 2
3	Upper Pillow Block Mount - Hook Frame	Step 3
4	Upper Motor Mounts - Motor	Step 4
5	Coupling - Shaft - Lower Pillow Block	Step 5
6	Shaft Collars - Offset Mass - Upper Pillow Block	Step 6
7	Polycarbonate Case	Step 7
8	Pole Attachment	Step 8
9	Battery Case	Step 9

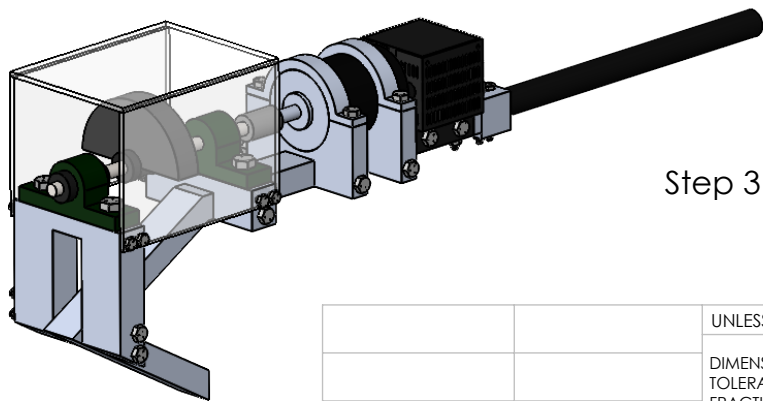
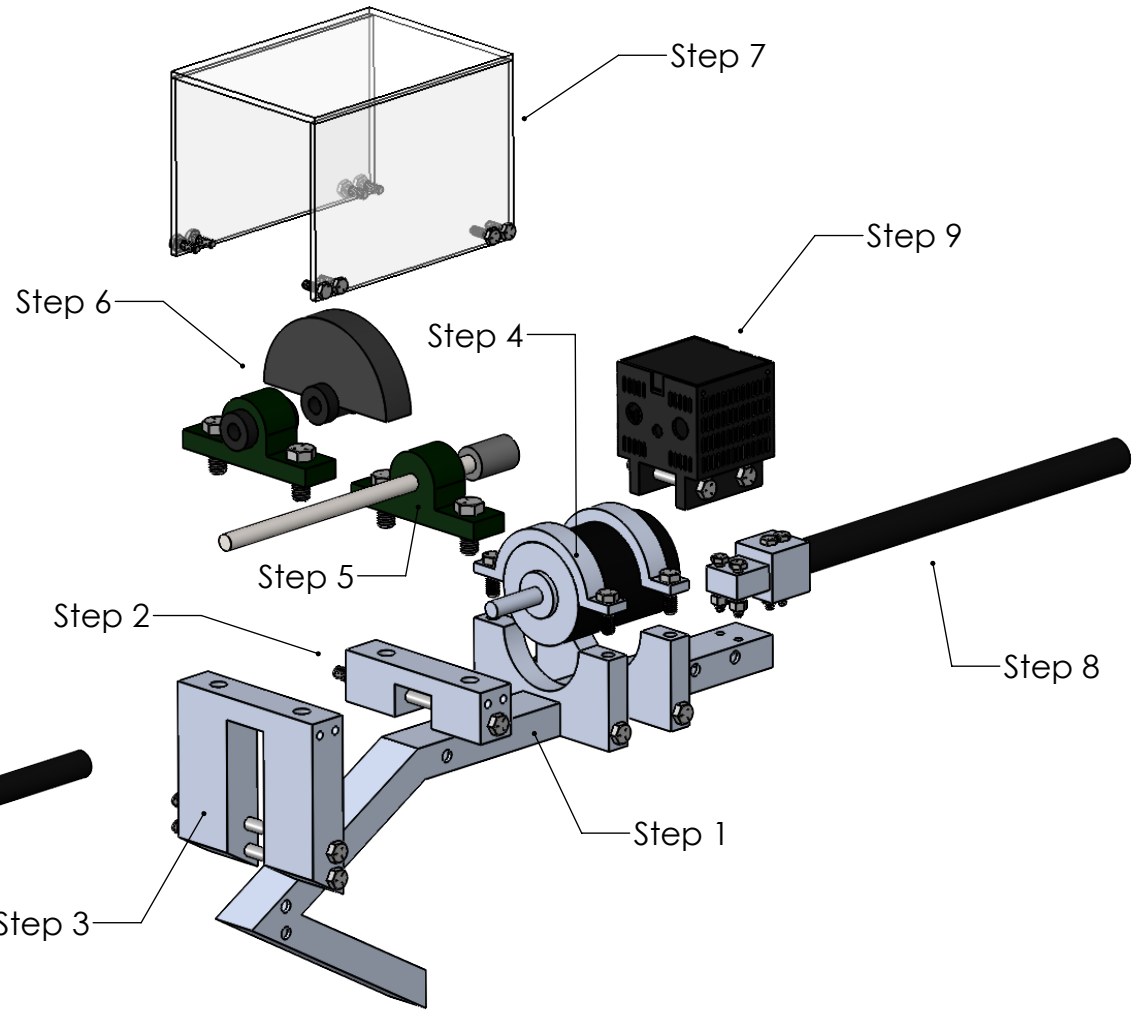

PROPRIETARY AND CONFIDENTIAL
 THE INFORMATION CONTAINED IN THIS DRAWING IS THE SOLE PROPERTY OF SDII T9 - RIPPLE EFFECT. ANY REPRODUCTION IN PART OR AS A WHOLE WITHOUT THE WRITTEN PERMISSION OF UTRGV IS PROHIBITED.

		UNLESS OTHERWISE SPECIFIED:		NAME	DATE
		DIMENSIONS ARE IN INCHES	DRAWN	MM	11/9/21
		TOLERANCES:	CHECKED		
		FRACTIONAL ±	ENG APPR.		
		ANGULAR: MACH ± BEND ±	MFG APPR.		
		TWO PLACE DECIMAL ±	Q.A.		
		THREE PLACE DECIMAL ±	COMMENTS:		
		INTERPRET GEOMETRIC TOLERANCING PER:			
		MATERIAL			
		N/A			
		FINISH			
		N/A			
NEXT ASSY	USED ON				
APPLICATION		DO NOT SCALE DRAWING			

SDII T9 - Ripple Effect		
TITLE:		
Mechanical Mesquite Bean Harvester Assembly		
SIZE	DWG. NO.	REV
A	MechMBH	0
SCALE: 1:5.5 WEIGHT:		SHEET 2 OF 13

B

B

A

A

2

1

Step 1

Step 2

Step 3

Step 4

Step 5

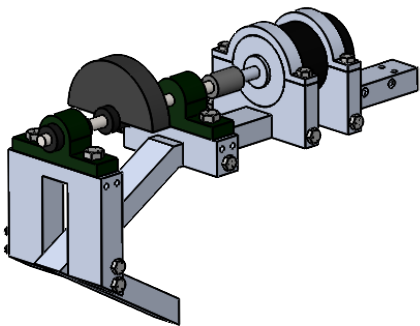
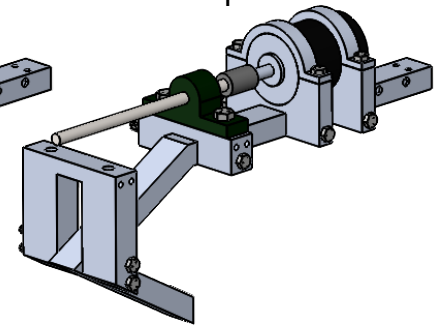
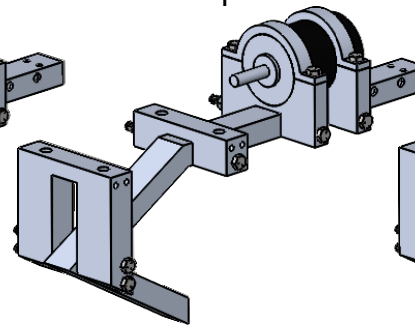
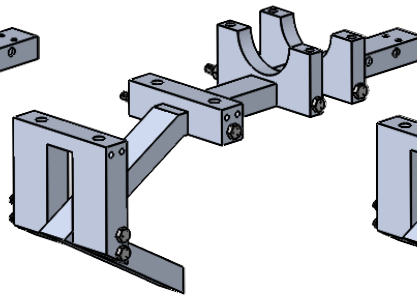
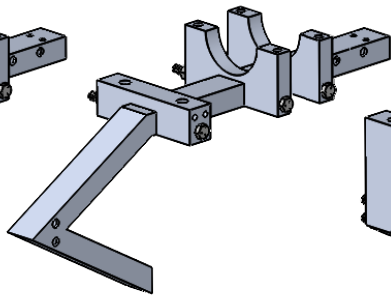
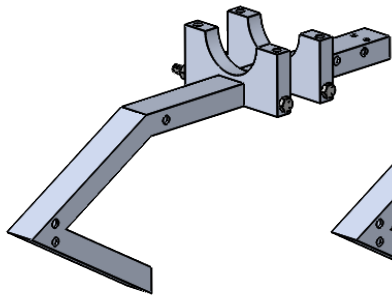

Step 6

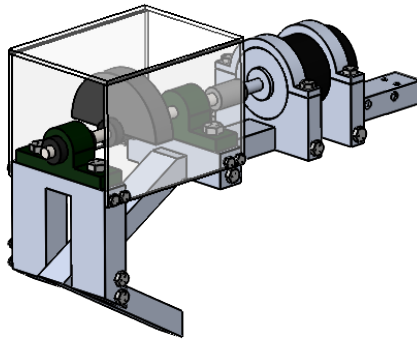

Step 7

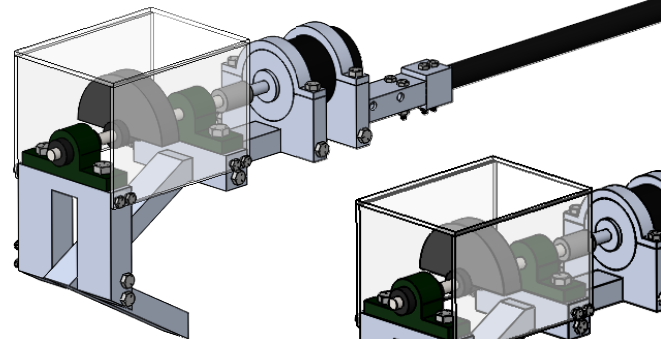

Step 8

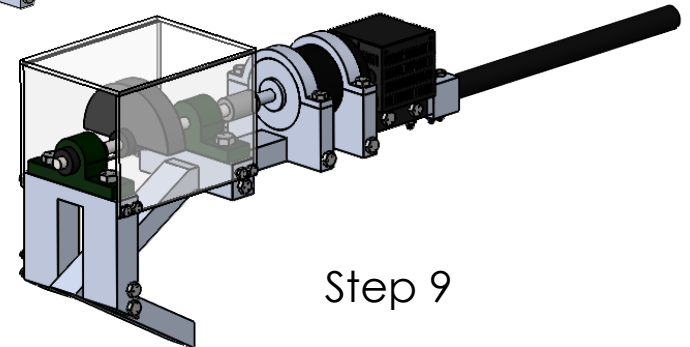

Step 9

B

B

A

A

PROPRIETARY AND CONFIDENTIAL
 THE INFORMATION CONTAINED IN THIS DRAWING IS THE SOLE PROPERTY OF SDII T9 - RIPPLE EFFECT. ANY REPRODUCTION IN PART OR AS A WHOLE WITHOUT THE WRITTEN PERMISSION OF UTRGV IS PROHIBITED.

		UNLESS OTHERWISE SPECIFIED:		NAME	DATE
		DIMENSIONS ARE IN INCHES	DRAWN	MM	11/9/21
		TOLERANCES:	CHECKED		
		FRACTIONAL ±	ENG APPR.		
		ANGULAR: MACH ± BEND ±	MFG APPR.		
		TWO PLACE DECIMAL ±	Q.A.		
		THREE PLACE DECIMAL ±	COMMENTS:		
		INTERPRET GEOMETRIC TOLERANCING PER:			
		MATERIAL			
		N/A			
		FINISH			
		N/A			
NEXT ASSY	USED ON				
APPLICATION		DO NOT SCALE DRAWING			

SDII T9 - Ripple Effect

TITLE:
Assembly Steps

SIZE	DWG. NO.	REV
A	MechMBH	0

SCALE: 1:8	WEIGHT:	SHEET 3 OF 13
------------	---------	---------------

2

1

2

1

ITEM NO.	DESCRIPTION	QTY.
1	Hook Frame	1
2	Lower Motor Mount	2
3	3/8" - 16 Bolt, 6 1/2 in. Length	2
4	3/8" - 16 Nylon Insert Lock Nut	2

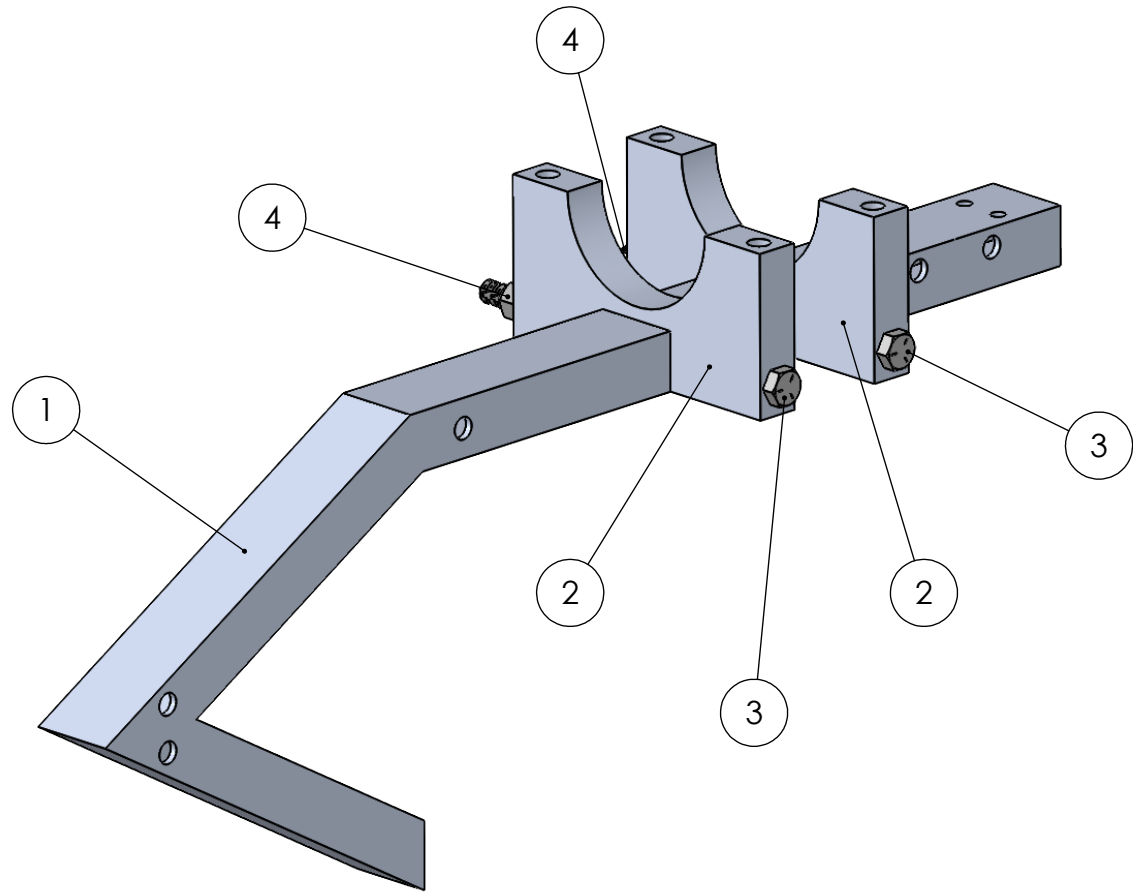

B

B

A

A

		UNLESS OTHERWISE SPECIFIED:		NAME	DATE	SDII T9 - Ripple Effect TITLE: <h1>Step 1</h1>		
		DIMENSIONS ARE IN INCHES		DRAWN	MM			11/9/21
		TOLERANCES:		CHECKED				
		FRACTIONAL ±		ENG APPR.				
		ANGULAR: MACH ± BEND ±		MFG APPR.				
		TWO PLACE DECIMAL ±		Q.A.				
		THREE PLACE DECIMAL ±		COMMENTS:				
		INTERPRET GEOMETRIC TOLERANCING PER:						
		MATERIAL		N/A		SIZE	DWG. NO.	REV
		FINISH		N/A		A	MechMBH	0
NEXT ASSY	USED ON					SCALE: 1:3	WEIGHT:	SHEET 4 OF 13
APPLICATION		DO NOT SCALE DRAWING						

PROPRIETARY AND CONFIDENTIAL
 THE INFORMATION CONTAINED IN THIS DRAWING IS THE SOLE PROPERTY OF SDII T9 - RIPPLE EFFECT. ANY REPRODUCTION IN PART OR AS A WHOLE WITHOUT THE WRITTEN PERMISSION OF UTRGV IS PROHIBITED.

2

1

2

1

ITEM NO.	DESCRIPTION	QTY.
3	3/8" - 16 Bolt, 6 1/2 in. Length	1
4	3/8" - 16 Nylon Insert Lock Nut	1
5	Lower Pillow Block Mount	1

B

B

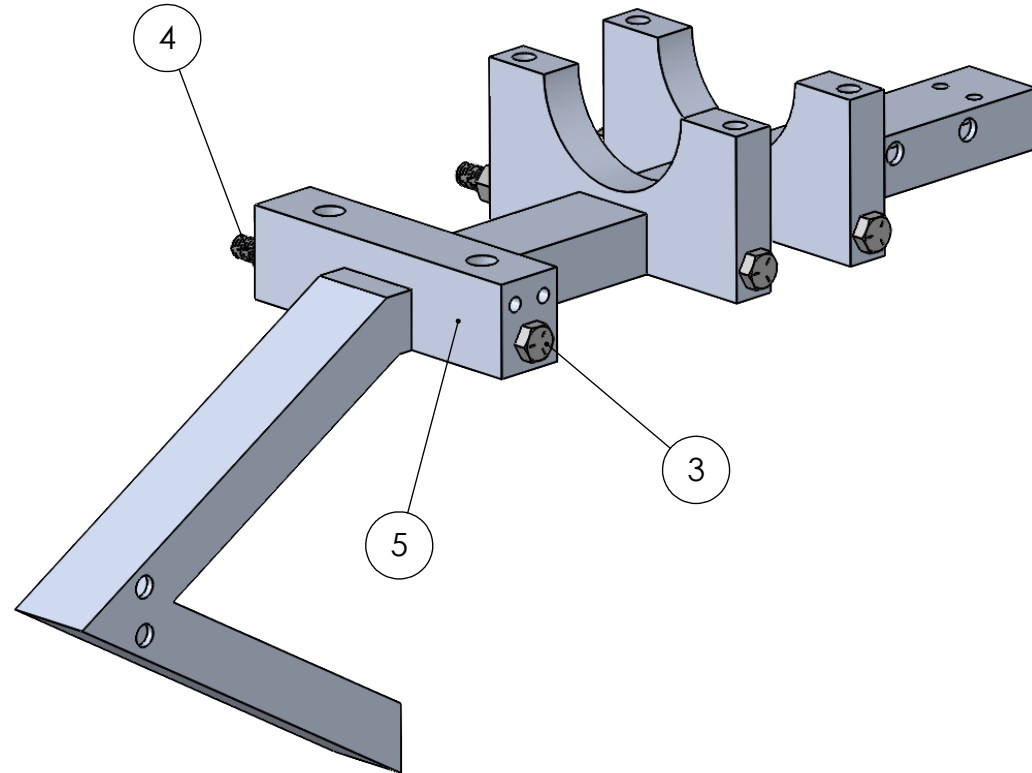

A

A

		UNLESS OTHERWISE SPECIFIED:		NAME	DATE	SDII T9 - Ripple Effect TITLE: <h1>Step 2</h1>			
		DIMENSIONS ARE IN INCHES		DRAWN	MM			11/10/21	
		TOLERANCES:		CHECKED					
		FRACTIONAL ±		ENG APPR.					
		ANGULAR: MACH ± BEND ±		MFG APPR.					
		TWO PLACE DECIMAL ±		Q.A.					
		THREE PLACE DECIMAL ±		COMMENTS:					
		INTERPRET GEOMETRIC TOLERANCING PER:							
		MATERIAL				SIZE	DWG. NO.	REV	
		N/A				A	MechMBH	0	
NEXT ASSY	USED ON	FINISH				SCALE: 1:3		WEIGHT:	SHEET 5 OF 13
		N/A							
APPLICATION		DO NOT SCALE DRAWING							

PROPRIETARY AND CONFIDENTIAL
 THE INFORMATION CONTAINED IN THIS DRAWING IS THE SOLE PROPERTY OF SDII T9 - RIPPLE EFFECT. ANY REPRODUCTION IN PART OR AS A WHOLE WITHOUT THE WRITTEN PERMISSION OF UTRGV IS PROHIBITED.

2

1

2

1

ITEM NO.	DESCRIPTION	QTY.
3	3/8" - 16 Bolt, 6 1/2 in. Length	2
4	3/8" - 16 Nylon Insert Lock Nut	2
6	Upper Pillow Block Mount	1

B

B

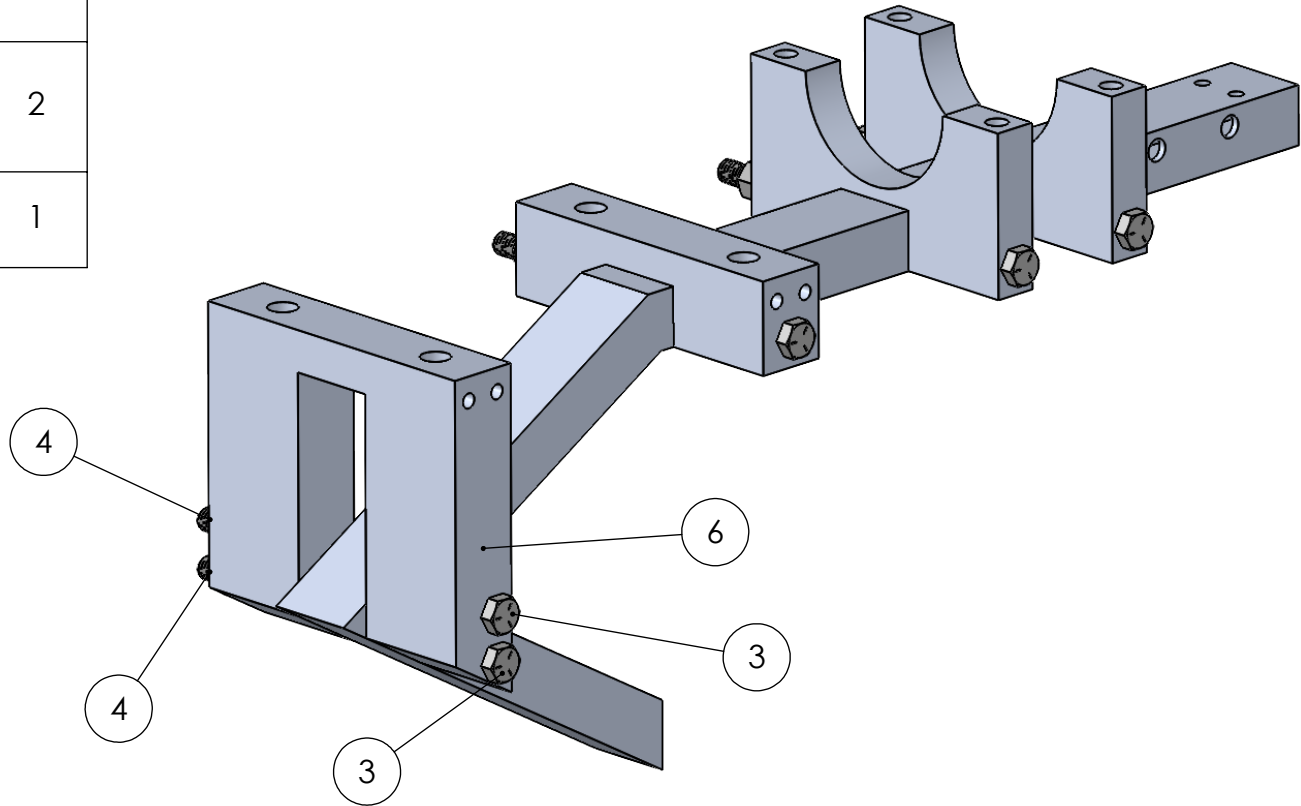

A

A

PROPRIETARY AND CONFIDENTIAL
 THE INFORMATION CONTAINED IN THIS DRAWING IS THE SOLE PROPERTY OF SDII T9 - Ripple Effect. ANY REPRODUCTION IN PART OR AS A WHOLE WITHOUT THE WRITTEN PERMISSION OF UTRGV IS PROHIBITED.

		UNLESS OTHERWISE SPECIFIED:		NAME	DATE
		DIMENSIONS ARE IN INCHES	DRAWN	MM	11/10/21
		TOLERANCES:	CHECKED		
		FRACTIONAL ±	ENG APPR.		
		ANGULAR: MACH ± BEND ±	MFG APPR.		
		TWO PLACE DECIMAL ±	Q.A.		
		THREE PLACE DECIMAL ±	COMMENTS:		
		INTERPRET GEOMETRIC TOLERANCING PER:			
		MATERIAL			
		N/A			
NEXT ASSY	USED ON	FINISH			
		N/A			
APPLICATION		DO NOT SCALE DRAWING			

SDII T9 - Ripple Effect

TITLE:
Step 3

SIZE	DWG. NO.	REV
A	MechMBH	0

SCALE: 1:3	WEIGHT:	SHEET 6 OF 13
------------	---------	---------------

2

1

2

1

ITEM NO.	DESCRIPTION	QTY.
7	Motor	1
8	Upper Motor Mount	2
9	3/8" - 16 Bolt, 1 in. Length	4

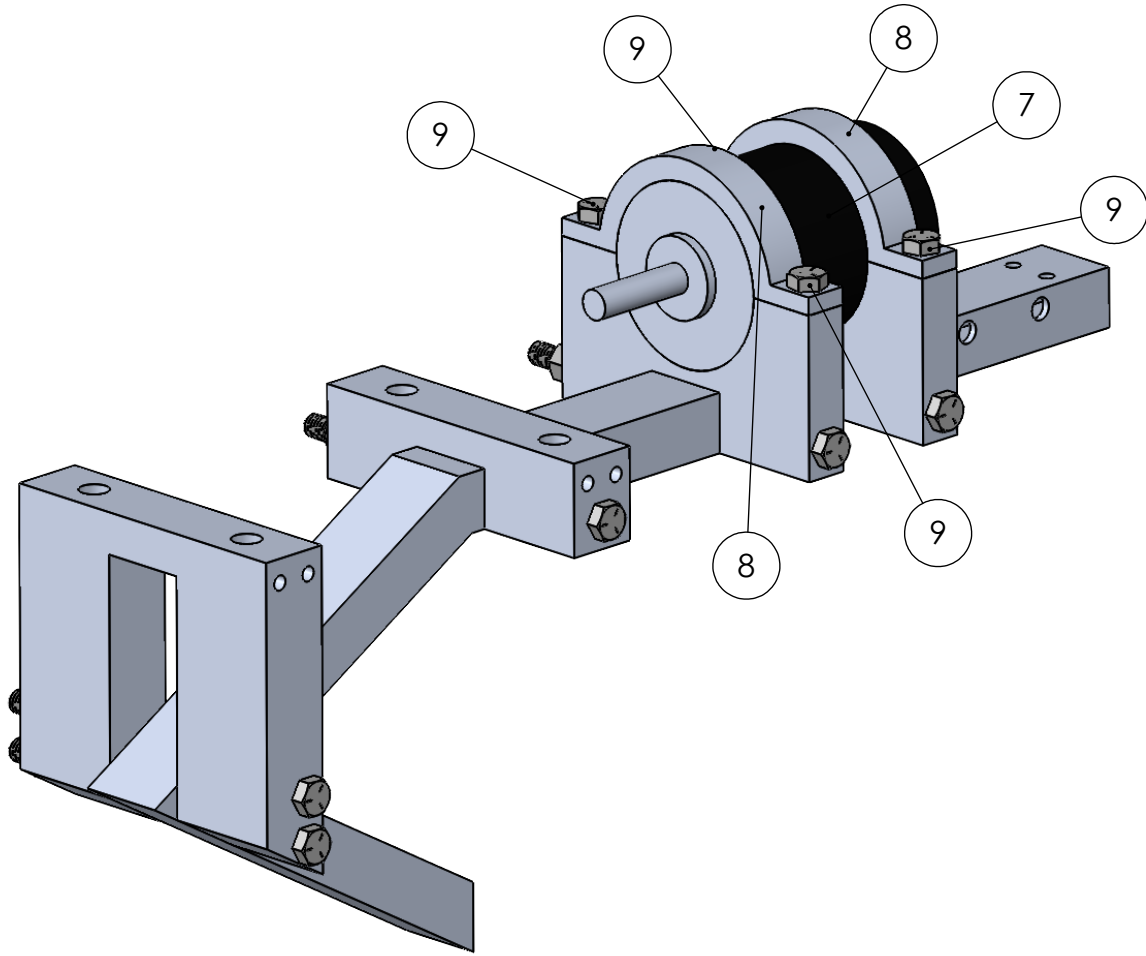

B

B

A

A

PROPRIETARY AND CONFIDENTIAL
 THE INFORMATION CONTAINED IN THIS DRAWING IS THE SOLE PROPERTY OF SDII T9 - RIPPLE EFFECT. ANY REPRODUCTION IN PART OR AS A WHOLE WITHOUT THE WRITTEN PERMISSION OF UTRGV IS PROHIBITED.

		UNLESS OTHERWISE SPECIFIED:		NAME	DATE
		DIMENSIONS ARE IN INCHES	DRAWN	MM	11/10/21
		TOLERANCES:	CHECKED		
		FRACTIONAL ±	ENG APPR.		
		ANGULAR: MACH ± BEND ±	MFG APPR.		
		TWO PLACE DECIMAL ±	Q.A.		
		THREE PLACE DECIMAL ±	COMMENTS:		
		INTERPRET GEOMETRIC TOLERANCING PER:			
		MATERIAL			
		N/A			
		FINISH			
		N/A			
NEXT ASSY	USED ON				
APPLICATION		DO NOT SCALE DRAWING			

SDII T9 - Ripple Effect

TITLE:
Step 4

SIZE	DWG. NO.	REV
A	MechMBH	0

SCALE: 1:3	WEIGHT:	SHEET 7 OF 13
------------	---------	---------------

2

1

2

1

ITEM NO.	DESCRIPTION	QTY.
10	Coupling	1
11	Shaft	1
12	Pillow Block	1
13	1/2" - 13 Bolt, 1 1/4 in. Length	2

B

B

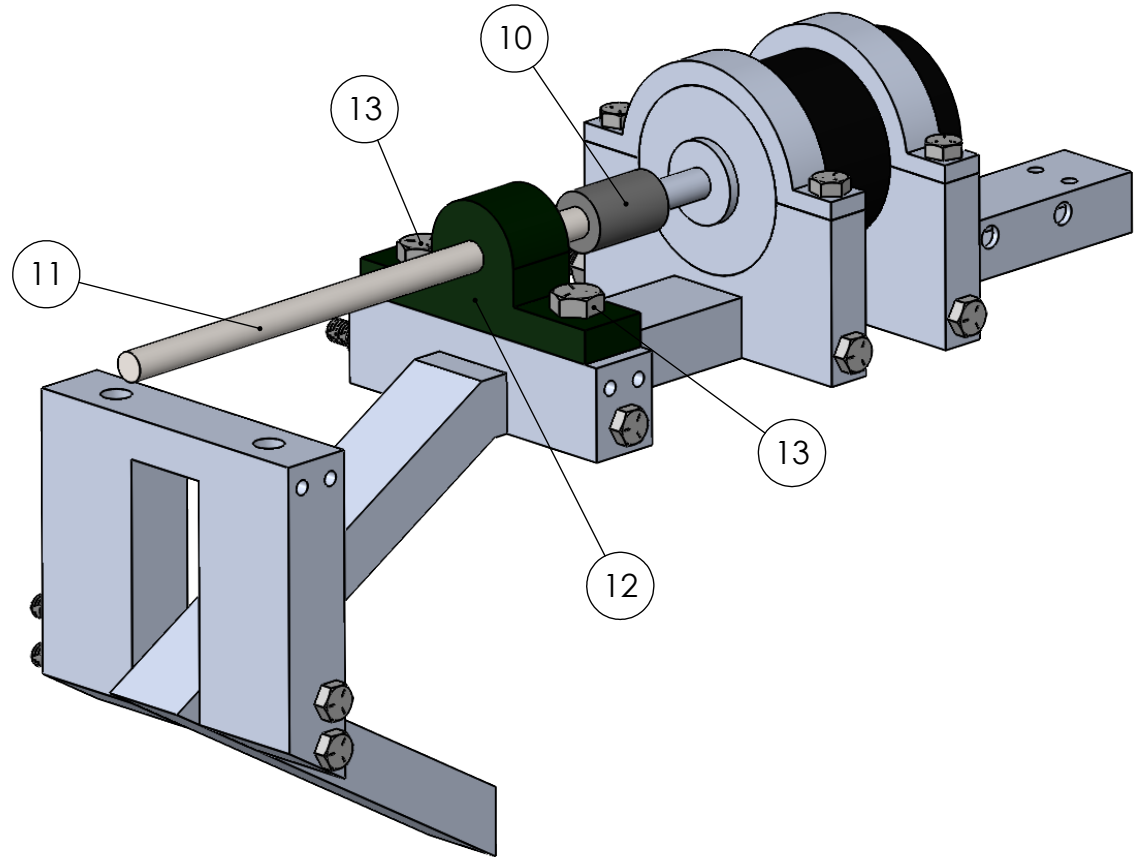

A

A

		UNLESS OTHERWISE SPECIFIED:		NAME	DATE	SDII T9 - Ripple Effect TITLE: <h1>Step 5</h1>		
		DIMENSIONS ARE IN INCHES		DRAWN	MM			11/10/21
		TOLERANCES:		CHECKED				
		FRACTIONAL ±		ENG APPR.				
		ANGULAR: MACH ± BEND ±		MFG APPR.				
		TWO PLACE DECIMAL ±		Q.A.				
		THREE PLACE DECIMAL ±		COMMENTS:				
		INTERPRET GEOMETRIC TOLERANCING PER:						
		MATERIAL				SIZE	DWG. NO.	REV
		N/A				A	MechMBH	0
NEXT ASSY	USED ON	FINISH				SCALE: 1:3		WEIGHT:
		N/A				SHEET 8 OF 13		
APPLICATION		DO NOT SCALE DRAWING						

PROPRIETARY AND CONFIDENTIAL
 THE INFORMATION CONTAINED IN THIS DRAWING IS THE SOLE PROPERTY OF SDII T9 - RIPPLE EFFECT. ANY REPRODUCTION IN PART OR AS A WHOLE WITHOUT THE WRITTEN PERMISSION OF UTRGV IS PROHIBITED.

2

1

2

1

ITEM NO.	DESCRIPTION	QTY.
12	Pillow Block	1
13	1/2" - 13 Bolt, 1 1/4 in. Length	2
14	Shaft Collar	4
15	Offset Mass	1

B

B

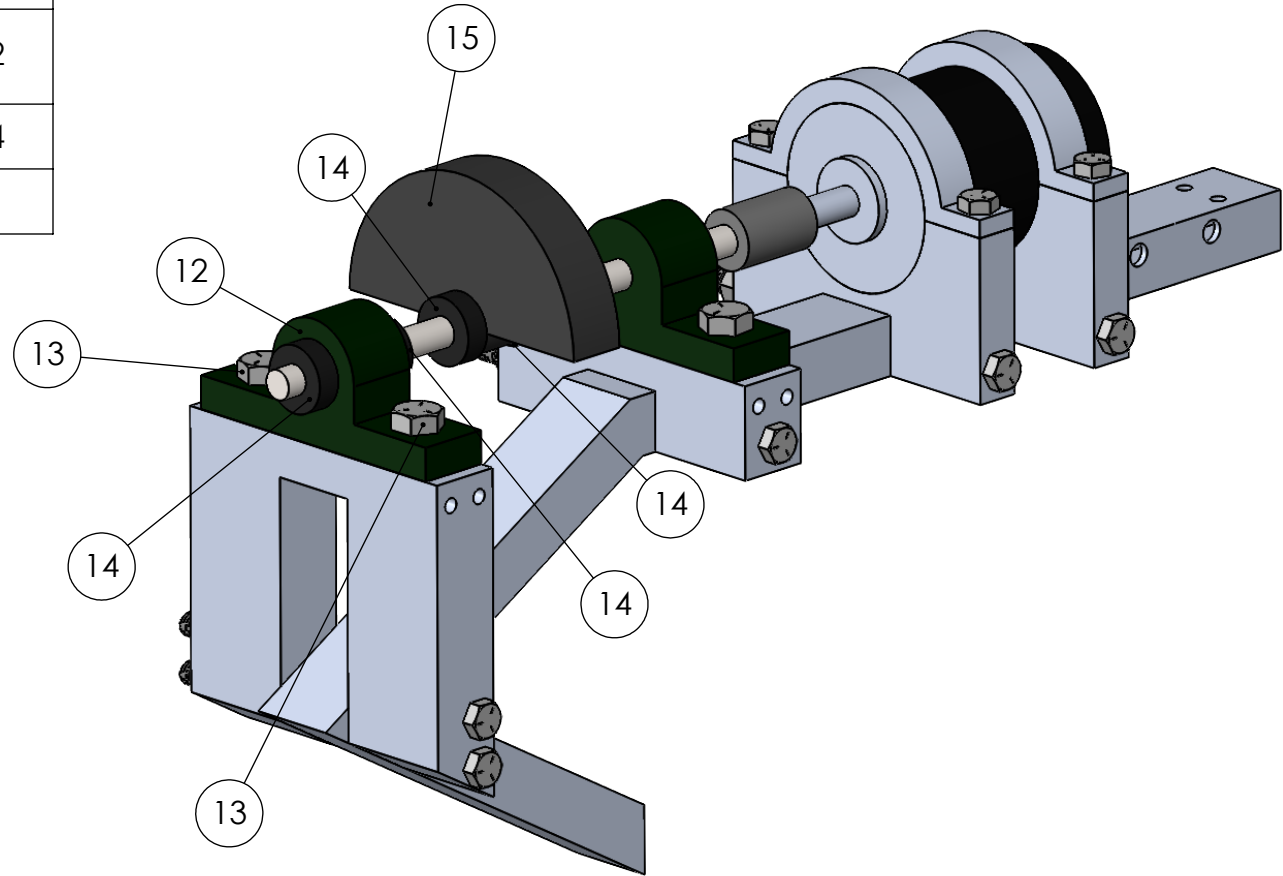

A

A

		UNLESS OTHERWISE SPECIFIED:	NAME	DATE	SDII T9 - Ripple Effect TITLE: <h1>Step 6</h1>		
		DIMENSIONS ARE IN INCHES	DRAWN	MM			11/10/21
		TOLERANCES:	CHECKED				
		FRACTIONAL ±	ENG APPR.				
		ANGULAR: MACH ± BEND ±	MFG APPR.				
		TWO PLACE DECIMAL ±	Q.A.				
		THREE PLACE DECIMAL ±	COMMENTS:				
		INTERPRET GEOMETRIC TOLERANCING PER:					
		MATERIAL	N/A				
		FINISH	N/A				
NEXT ASSY	USED ON					SIZE DWG. NO. REV A MechMBH 0	
APPLICATION		DO NOT SCALE DRAWING				SCALE: 1:3 WEIGHT: SHEET 9 OF 13	

PROPRIETARY AND CONFIDENTIAL
 THE INFORMATION CONTAINED IN THIS DRAWING IS THE SOLE PROPERTY OF SDII T9 - RIPPLE EFFECT. ANY REPRODUCTION IN PART OR AS A WHOLE WITHOUT THE WRITTEN PERMISSION OF UTRGV IS PROHIBITED.

2

1

2

1

ITEM NO.	DESCRIPTION	QTY.
16	Polycarbonate Case	1
17	1/4" - 20 Bolt, 3/4 in. Length	8

B

NOTE: Four 1/4" - 20 Bolts, 3/4 in. Length (Item #17) on Back Side

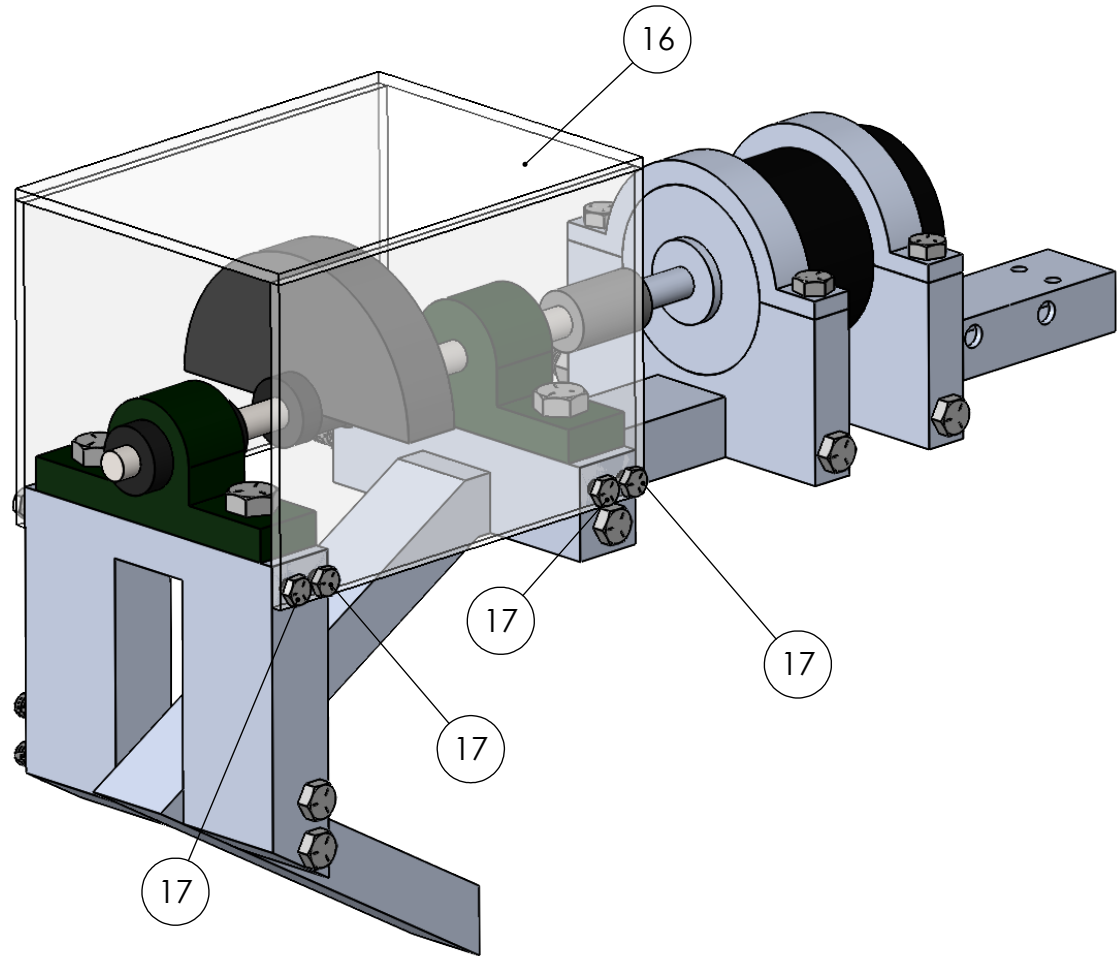

B

A

		UNLESS OTHERWISE SPECIFIED:		NAME	DATE	SDII T9 - Ripple Effect TITLE: <h1>Step 7</h1>		
		DIMENSIONS ARE IN INCHES		DRAWN	MM			11/10/21
		TOLERANCES:		CHECKED				
		FRACTIONAL ±		ENG APPR.				
		ANGULAR: MACH ± BEND ±		MFG APPR.				
		TWO PLACE DECIMAL ±		Q.A.				
		THREE PLACE DECIMAL ±		COMMENTS:				
		INTERPRET GEOMETRIC TOLERANCING PER:				SIZE	DWG. NO.	REV
		MATERIAL				A	MechMBH	0
		FINISH				SCALE: 1:3	WEIGHT:	SHEET 10 OF 13
NEXT ASSY	USED ON	DO NOT SCALE DRAWING						
APPLICATION								

A

PROPRIETARY AND CONFIDENTIAL
 THE INFORMATION CONTAINED IN THIS DRAWING IS THE SOLE PROPERTY OF SDII T9 - RIPPLE EFFECT. ANY REPRODUCTION IN PART OR AS A WHOLE WITHOUT THE WRITTEN PERMISSION OF UTRGV IS PROHIBITED.

2

1

ITEM NO.	DESCRIPTION	QTY.
18	Pole	1
19	Filling	1
20	Connector	1
21	1/4" - 20 Bolt, 2 in. Length	2
22	1/4" - 20 Bolt, 1 1/2 in. Length	2
23	1/4" - 20 Nylon Insert Lock Nut	4

B

B

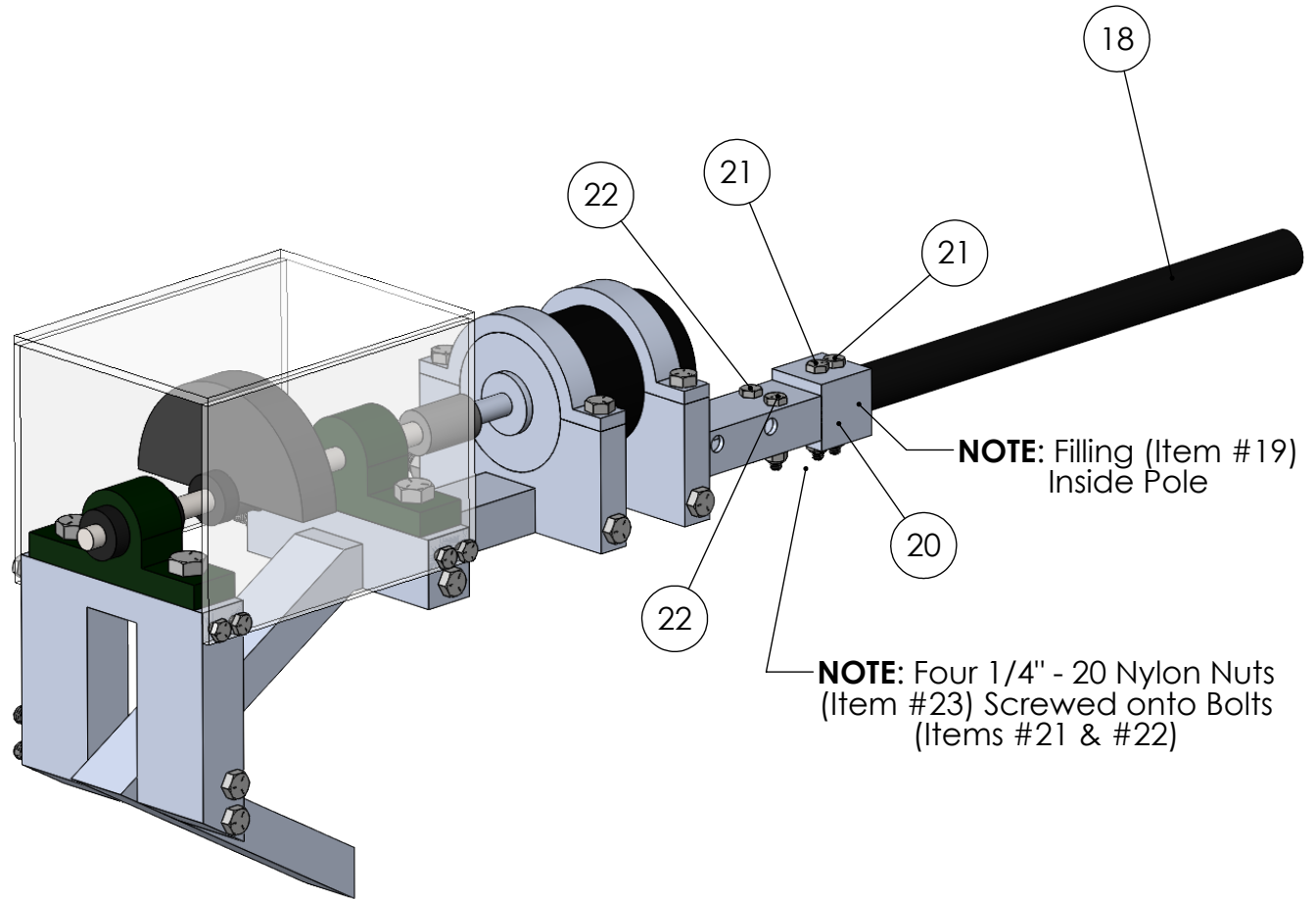

NOTE: Filling (Item #19) Inside Pole

NOTE: Four 1/4" - 20 Nylon Nuts (Item #23) Screwed onto Bolts (Items #21 & #22)

A

A

		UNLESS OTHERWISE SPECIFIED:		NAME	DATE	SDII T9 - Ripple Effect	
		DIMENSIONS ARE IN INCHES		DRAWN	MM		
		TOLERANCES:		CHECKED			TITLE:
		FRACTIONAL ±		ENG APPR.			Step 8
		ANGULAR: MACH ± BEND ±		MFG APPR.			
		TWO PLACE DECIMAL ±		Q.A.			
		THREE PLACE DECIMAL ±		COMMENTS:			
		INTERPRET GEOMETRIC TOLERANCING PER:					
		MATERIAL					
		N/A					
		FINISH					
		N/A					
NEXT ASSY	USED ON			SIZE	DWG. NO.	REV	
				A	MechMBH	0	
APPLICATION		DO NOT SCALE DRAWING		SCALE: 1:4	WEIGHT:	SHEET 11 OF 13	

PROPRIETARY AND CONFIDENTIAL
 THE INFORMATION CONTAINED IN THIS DRAWING IS THE SOLE PROPERTY OF SDII T9 - RIPPLE EFFECT. ANY REPRODUCTION IN PART OR AS A WHOLE WITHOUT THE WRITTEN PERMISSION OF UTRGV IS PROHIBITED.

ITEM NO.	DESCRIPTION	QTY.
4	3/8" - 16 Nylon Insert Lock Nut	2
24	Battery Case	1
25	3/8" - 16 Bolt, 3 in. Length	2

NOTE: Two 3/8" - 16 Nylon Nuts (Item #4) Screwed onto Bolts (Item #25)

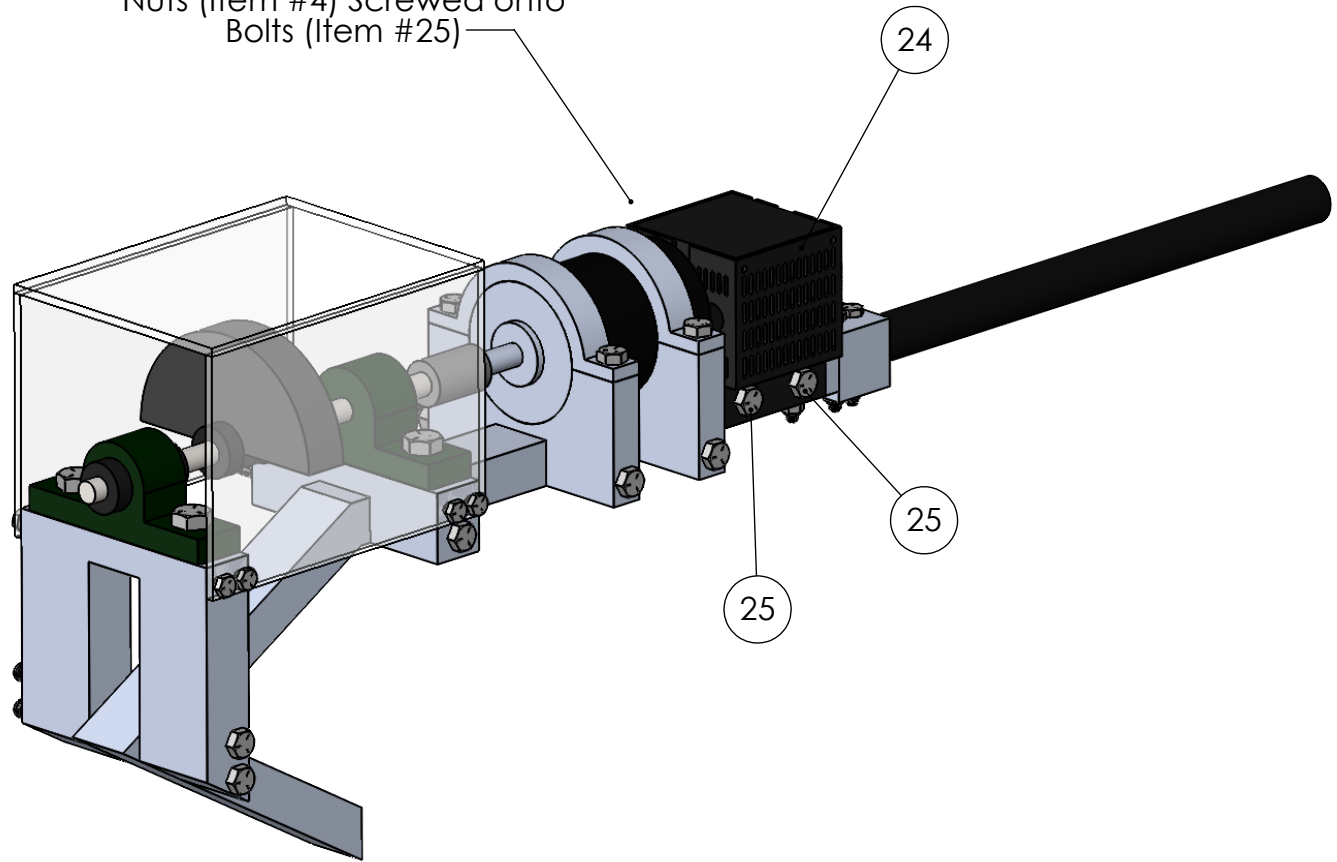

B

B

A

A

		UNLESS OTHERWISE SPECIFIED:		NAME	DATE	SDII T9 - Ripple Effect		
		DIMENSIONS ARE IN INCHES		DRAWN	MM			11/10/21
		TOLERANCES:		CHECKED			TITLE: Step 9	
		FRACTIONAL ±		ENG APPR.				
		ANGULAR: MACH ± BEND ±		MFG APPR.				
		TWO PLACE DECIMAL ±		Q.A.				
		THREE PLACE DECIMAL ±		COMMENTS:				
		INTERPRET GEOMETRIC TOLERANCING PER:				SIZE	DWG. NO.	REV
		MATERIAL				A	MechMBH	0
		FINISH				SCALE: 1:4		WEIGHT:
NEXT ASSY	USED ON	N/A				SHEET 12 OF 13		
APPLICATION		DO NOT SCALE DRAWING						

PROPRIETARY AND CONFIDENTIAL
THE INFORMATION CONTAINED IN THIS DRAWING IS THE SOLE PROPERTY OF SDII T9 - RIPPLE EFFECT. ANY REPRODUCTION IN PART OR AS A WHOLE WITHOUT THE WRITTEN PERMISSION OF UTRGV IS PROHIBITED.

2

1

B

B

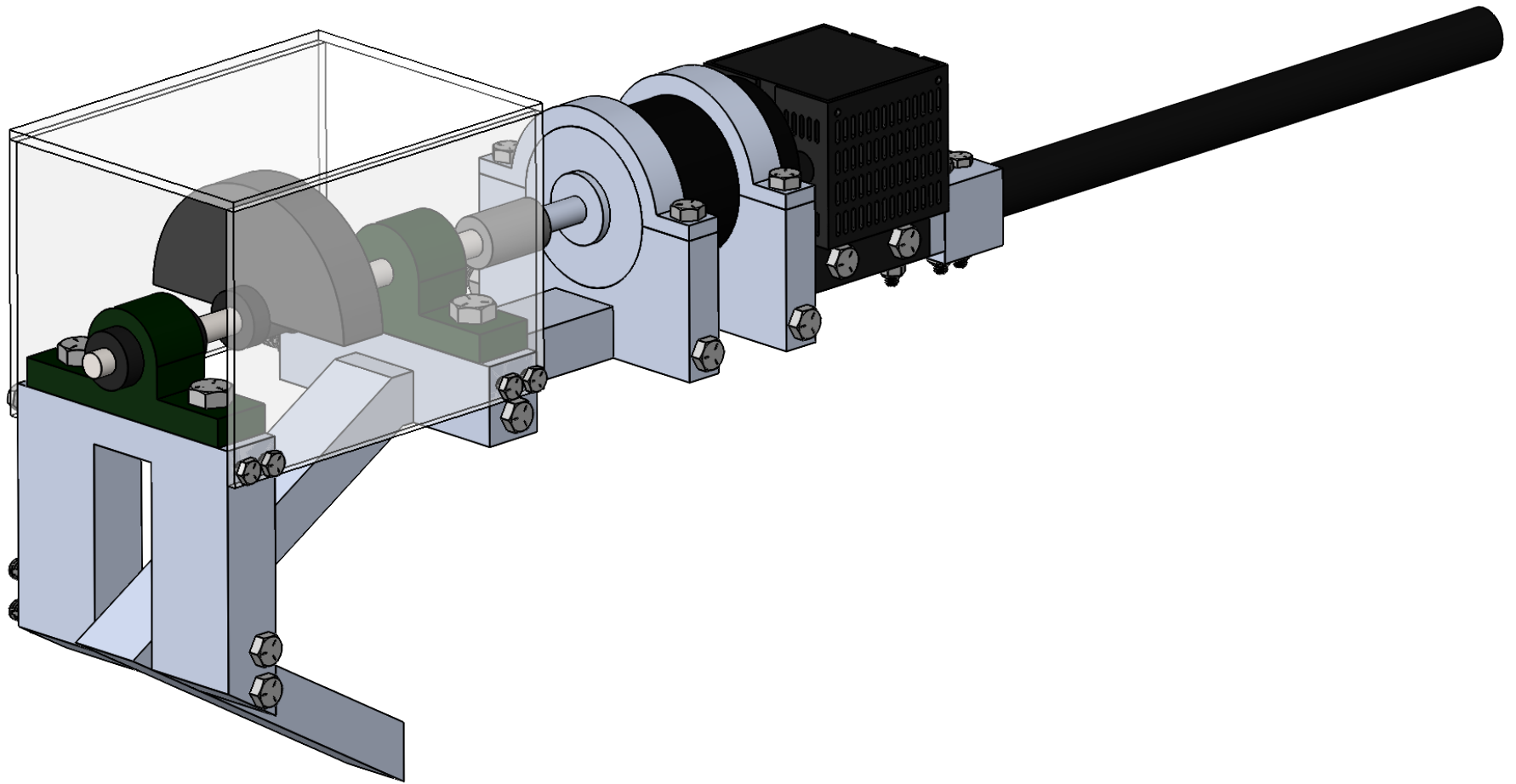

A

A

PROPRIETARY AND CONFIDENTIAL
 THE INFORMATION CONTAINED IN THIS DRAWING IS THE SOLE PROPERTY OF SDII T9 - RIPPLE EFFECT. ANY REPRODUCTION IN PART OR AS A WHOLE WITHOUT THE WRITTEN PERMISSION OF UTRGV IS PROHIBITED.

		UNLESS OTHERWISE SPECIFIED:		NAME	DATE
		DIMENSIONS ARE IN INCHES	DRAWN	MM	11/10/21
		TOLERANCES:	CHECKED		
		FRACTIONAL ±	ENG APPR.		
		ANGULAR: MACH ± BEND ±	MFG APPR.		
		TWO PLACE DECIMAL ±	Q.A.		
		THREE PLACE DECIMAL ±	COMMENTS:		
		INTERPRET GEOMETRIC TOLERANCING PER:			
		MATERIAL			
		N/A			
		FINISH			
		N/A			
NEXT ASSY	USED ON				
APPLICATION		DO NOT SCALE DRAWING			

SDII T9 - Ripple Effect

TITLE:
End Product

SIZE	DWG. NO.	REV
A	MechMBH	0

SCALE: 1:3	WEIGHT:	SHEET 13 OF 13
------------	---------	----------------

2

1